

LYLA RYE

Deviations

February 12 - March 12, 2022

GENERAL HARDWARE CONTEMPORARY

1520 Queen Street West Toronto M6R 1A4

416 - 821- 3060, info@generalhardware.ca

www.generalhardware.ca

General Hardware is pleased to present Lyla Rye's exhibition Deviations which marks Rye's fourth exhibition at the gallery.

The exhibition includes Deviations, a new series of prints, the Suspended Meditation photos and a number of sketchbook exchanges titled: Catch & Release.

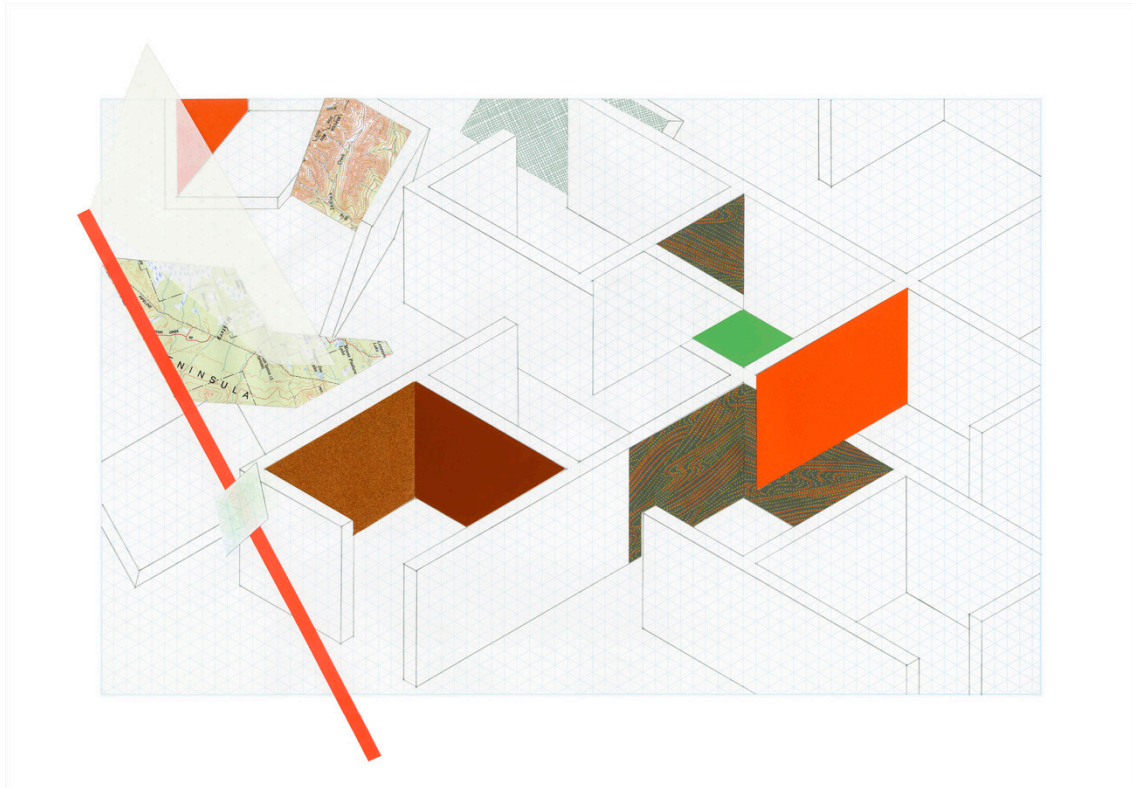

Deviations explores the structures we impose on time and space in a vain attempt to make sense of them. These 15 digital prints are based on collages that allude to those orders and systems with fragments of calendars, accounting books, maps, bingo cards, graph paper and paint swatches. Rye has played off the isometric grid paper on which the drawings were made by overlaying other grids and patterns. The collaged materials often end up undermining the illusionism of the original working drawings. In optically complicating the images, they deviate from their initial logical intent.

Lyla Rye, Deviations series, Archival digital prints, 16"x 24", Edition of 5



Suspended Meditation expands upon Rye's use of strategies referencing architectural scale, along with her focus on slowness, intricacy and material shifts in producing embodied encounters with space that unfold over time. Her digital prints reveal the contradictions inherent to the relationship between the real and illusionary qualities of still and moving images. The chaos of 21st-century life increasingly leads people to seek out various types of spaces, images, sounds and activities that reconnect them to nature, in order to calm their hearts and minds. A Meditation explores our ambivalent and complicated relationship to images that comment on the haphazard use and misuse of air, land and water. Pristine depictions of nature also form a part of everyday mainstream imagery, with nature videos even posted online as meditation aids. Rye considers the contradictory qualities of these two kinds of imagery.

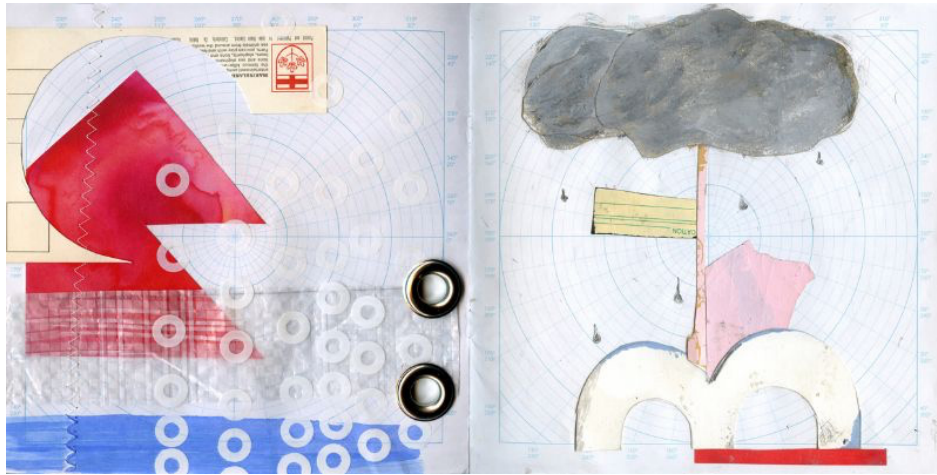

Catch and Release is a sketchbook exchange project that was a way to visually communicate with other artists over long distances. Each exchange began with two identical sketchbooks with either a square, polar, spherical, perspectival or isometric grid. Each artist responded to the environment of that grid and initiated an idea through drawing or collage. The sketchbooks were then exchanged and the other person tried to catch the concepts evoked and resolve the drawing. Artists released their drawings completely to the other to alter, extend or obliterate it entirely. The project gained new resonance in this time of social isolation and became a vital way to connect.

Collaborators:

John Dickson (Toronto)

Craig Eastland (Boston)

Jeff Feld (New York)

Catherine Heard (Windsor)

Suzanne Kammin (Brooklyn)

Matthew Kolakowski (London, UK)

Christina La Sala (San Francisco)

Meg Remy - musician, U.S. Girls (Toronto)

Victor Romao (Windsor)

Chantal Rousseau (Quebec)

Lena Dickson Rye (Toronto, ON)



Lyla Rye is a Toronto based artist, who began her studies in architecture. She works in installation, sculpture, video and photography to explore our experience of architectural space. Using angled forms, images, and the space itself, she creates encounters that require active viewing. Whether sculptural or video-based, the installations engage physically, optically, and conceptually, hailing us to our perception of time and space.

Rye received a BFA from York University and an MFA from the San Francisco Art Institute. For over 20 years her work has been exhibited in galleries across Canada and internationally including San Francisco, New York, Adelaide (Australia), Paris, and Berlin. She has exhibited at The Whitney Museum of American Art, The Power Plant, Southern Alberta Art Gallery, The Mendel Art Gallery, The Textile Museum of Canada and Koffler Gallery among others. Her work is included in collections such as The Art Gallery of Nova Scotia, York University, Cadillac Fairview Corporation, Tom Thomson Art Gallery and The Robert McLaughlin Gallery. She has founded and exhibited with a number of collectives including NetherMind, 5 things hic and Persona Volare. Recent exhibitions include Abide at TRUCK Contemporary Art in Calgary, The Karachi Biennale in Pakistan and a current solo exhibition A Meditation at PREFIX Institute of Contemporary Art in Toronto.

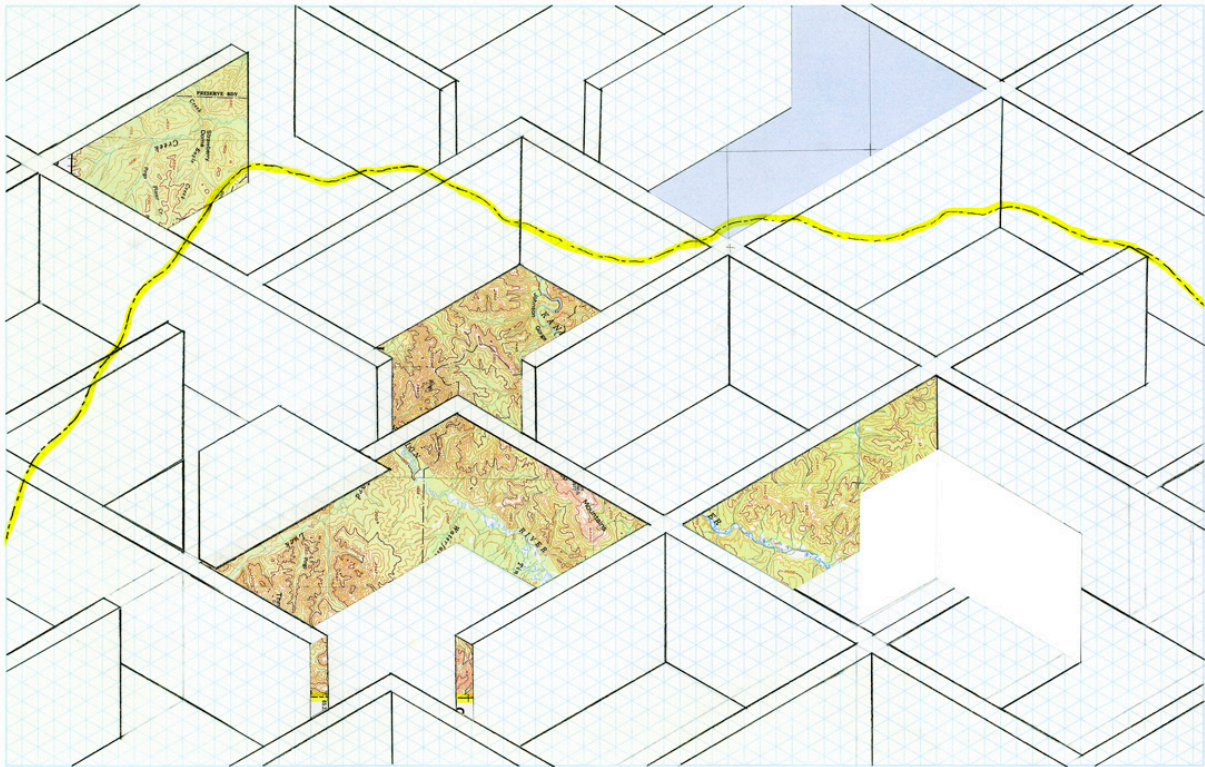

Lyla Rye

Deviation, Trail, 2021

Archival Digital Print, 16 x 24 inches

Edition of 5

Value: \$1200

generalhardware.ca

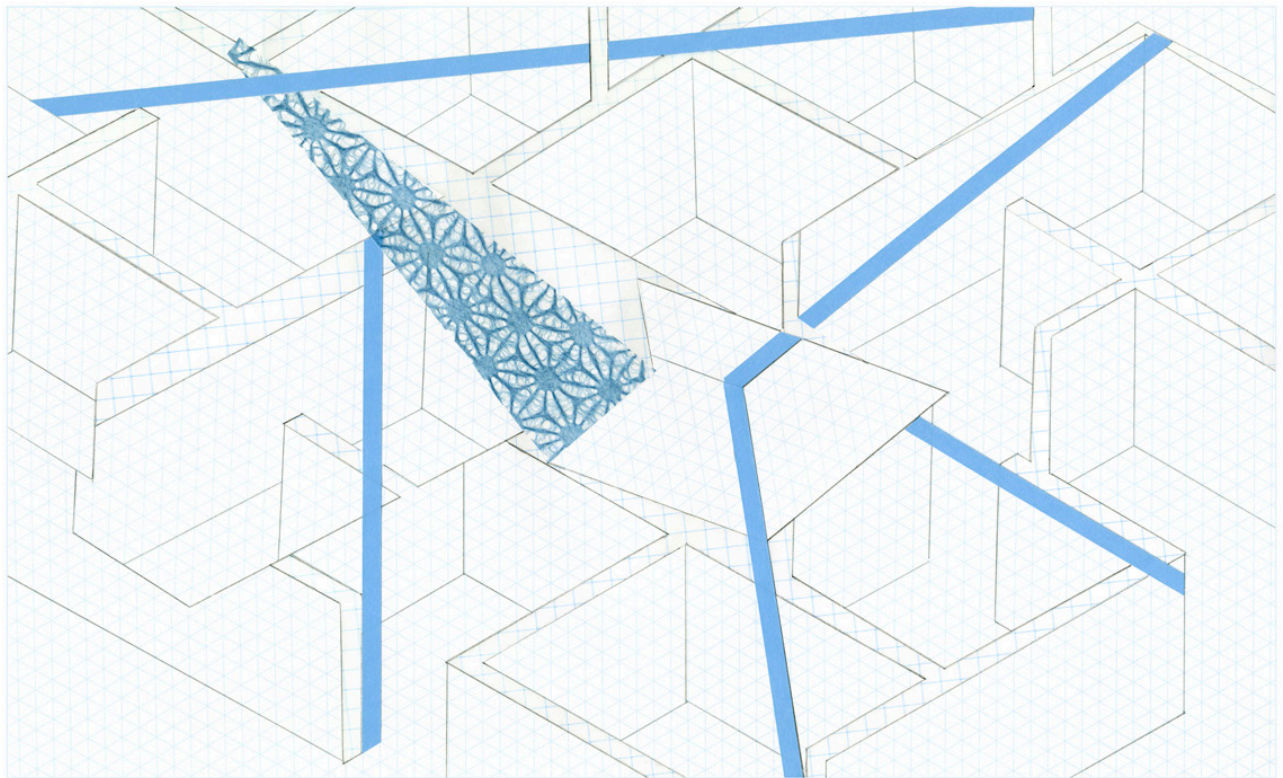

Lyla Rye

Deviation, Blue Lace, 2021

Archival Digital Print, 16 x 24 inches

Edition of 5

Value: \$1200

generalhardware.ca

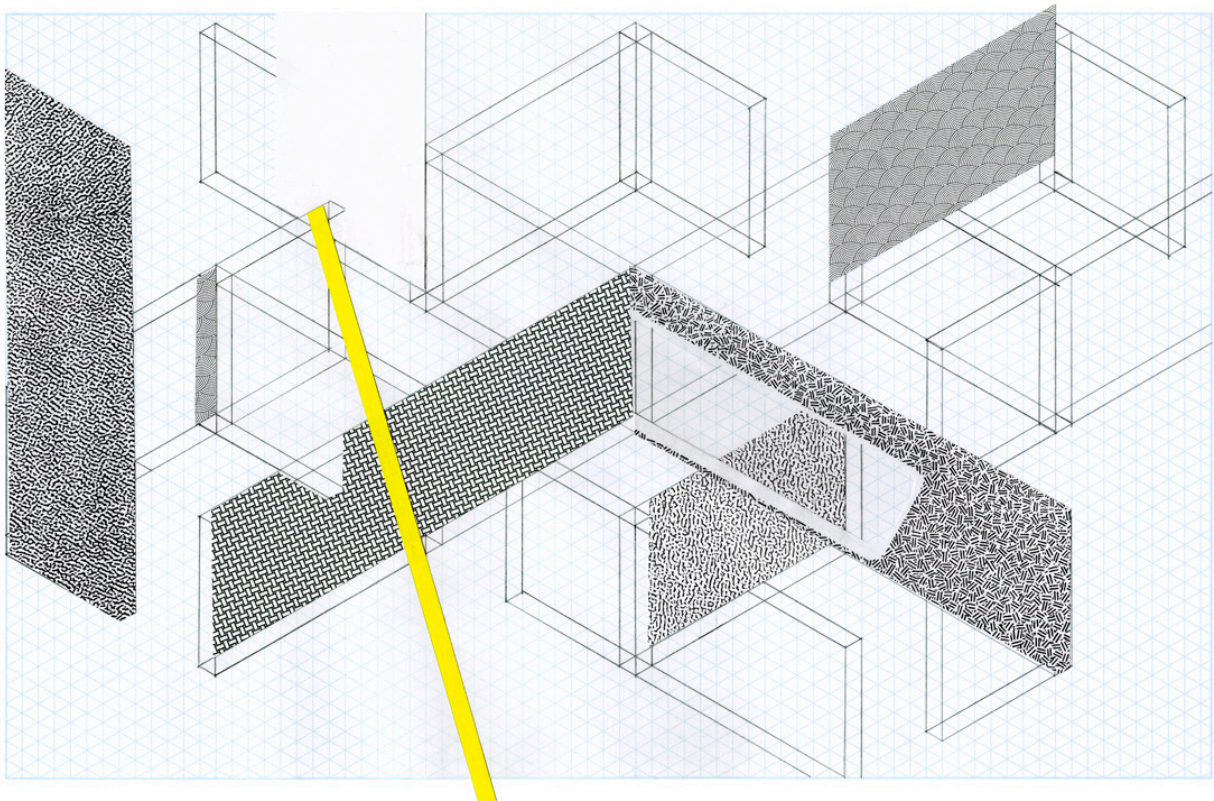

Lyla Rye

Deviation, Spacial Envelope, 2021

Archival Digital Print, 16 x 24 inches

Edition of 5

Value: \$1200

generalhardware.ca

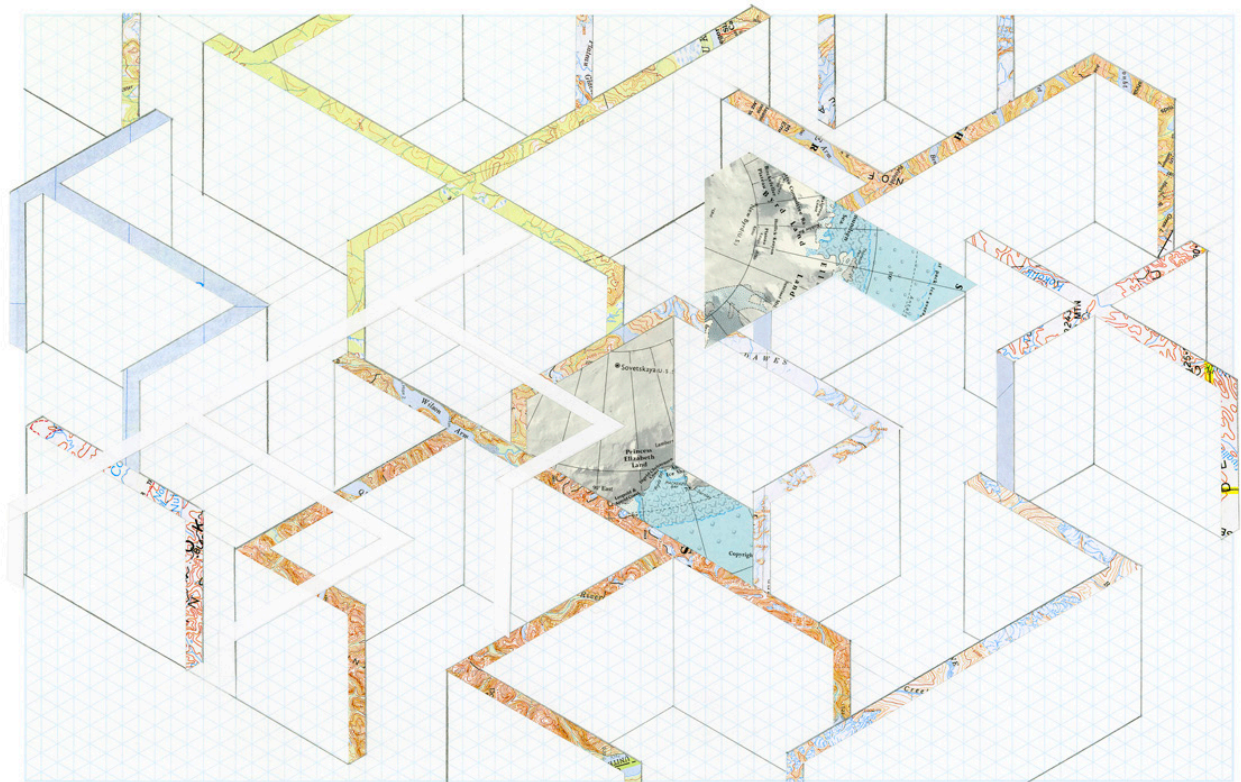

Lyla Rye
Deviation, Mapping Boundaries, 2021
Archival Digital Print, 16 x 24 inches
Edition of 5
Value: \$1200

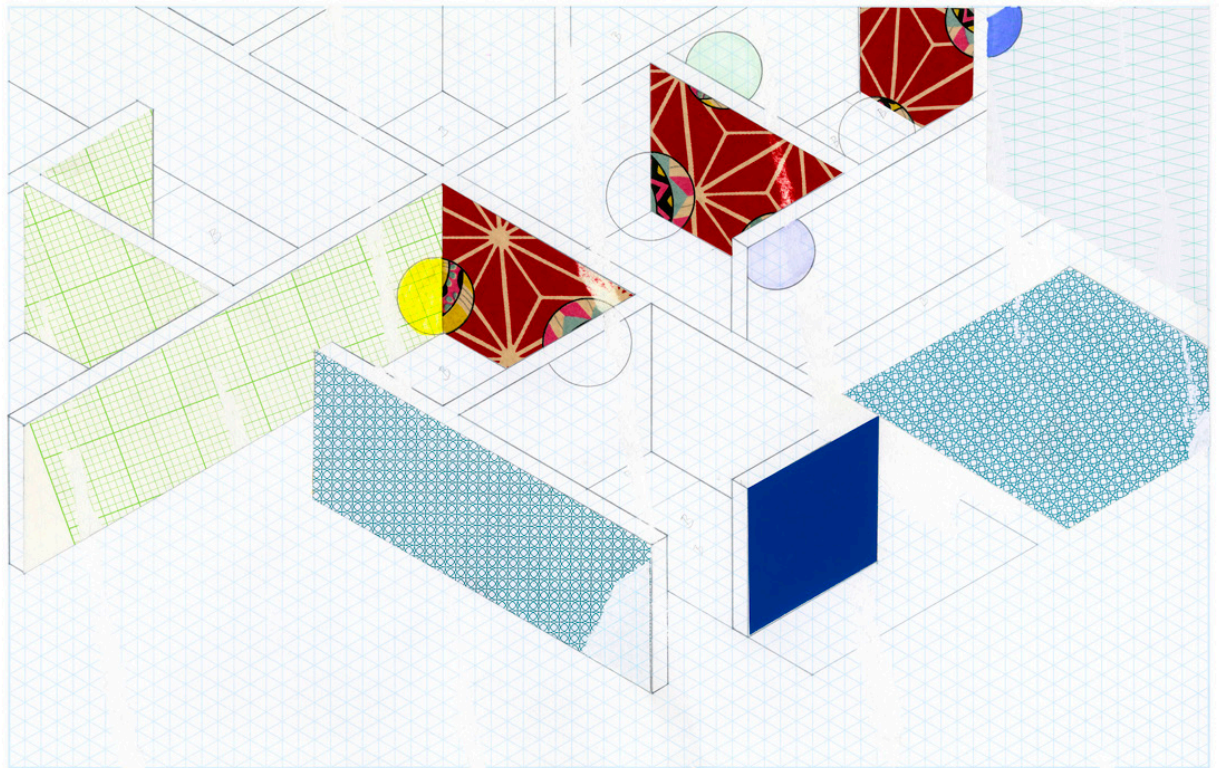

Lyla Rye

Deviation, Circles, 2021

Archival Digital Print , 16 x 24 inches

Edition of 5

Value: \$1200

generalhardware.ca

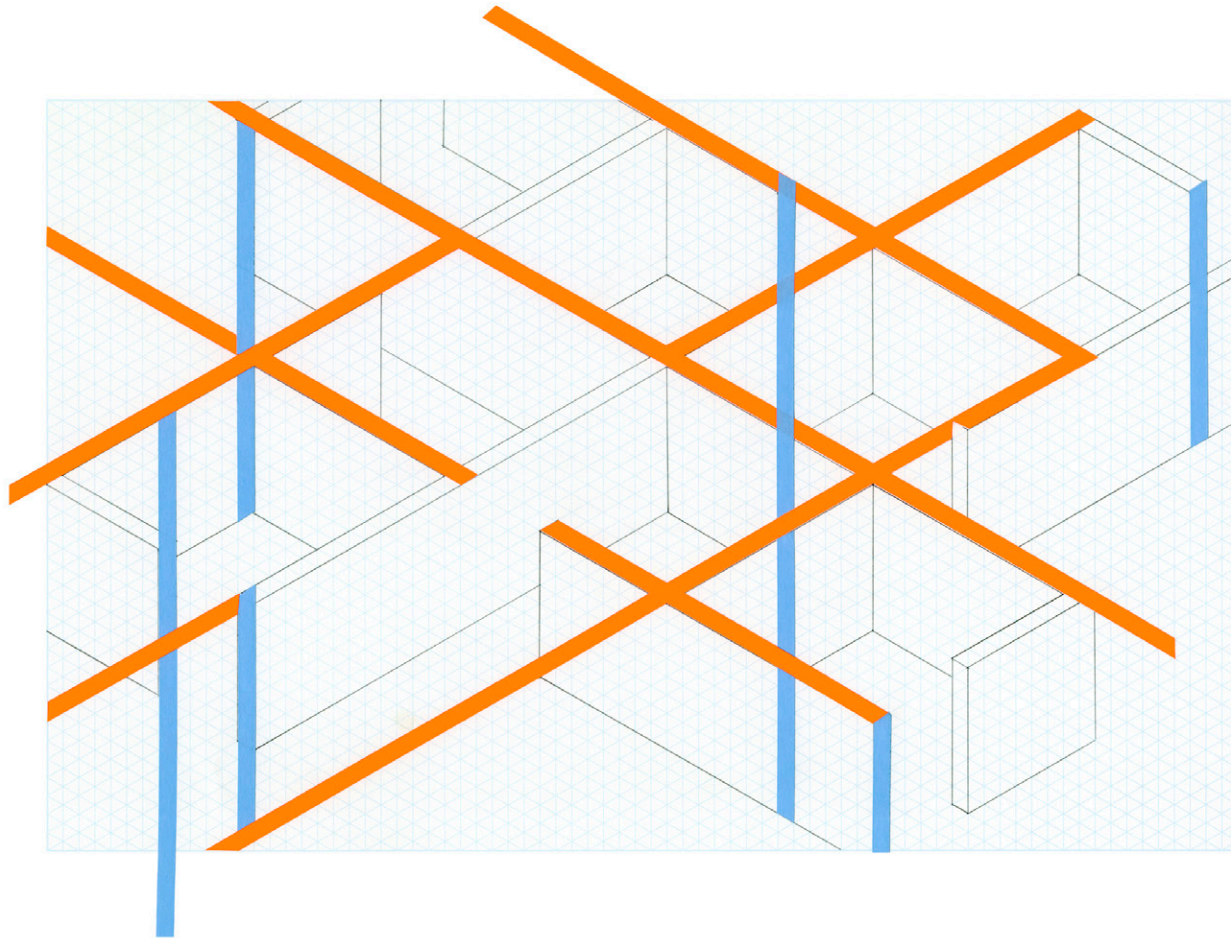

Lyla Rye

Deviation, Blue Edges, 2021

Archival Digital Print, with screen printing

16 x 24 inches

Edition of 5

Value: \$1200

generalhardware.ca

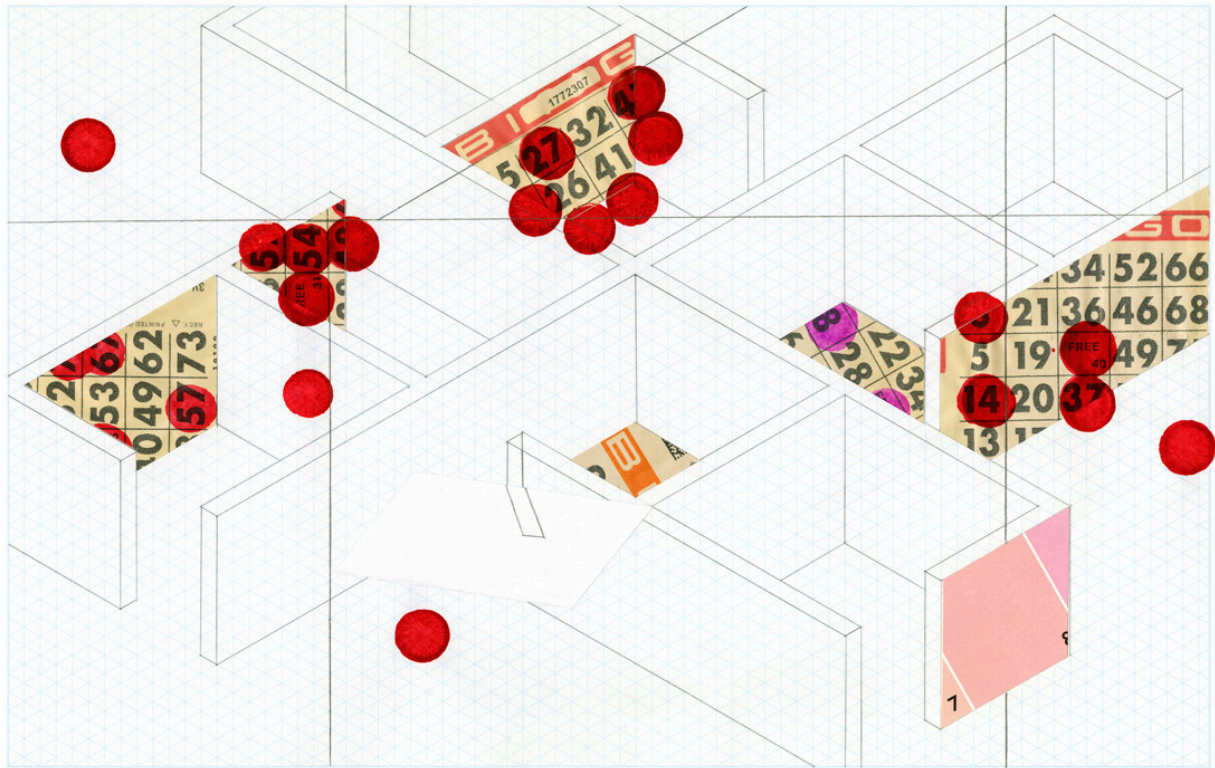

Lyla Rye

Deviation, Bingo Grid, 2021

Archival Digital Print, 16 x 24 inches

Edition of 5

Value: \$1200

generalhardware.ca

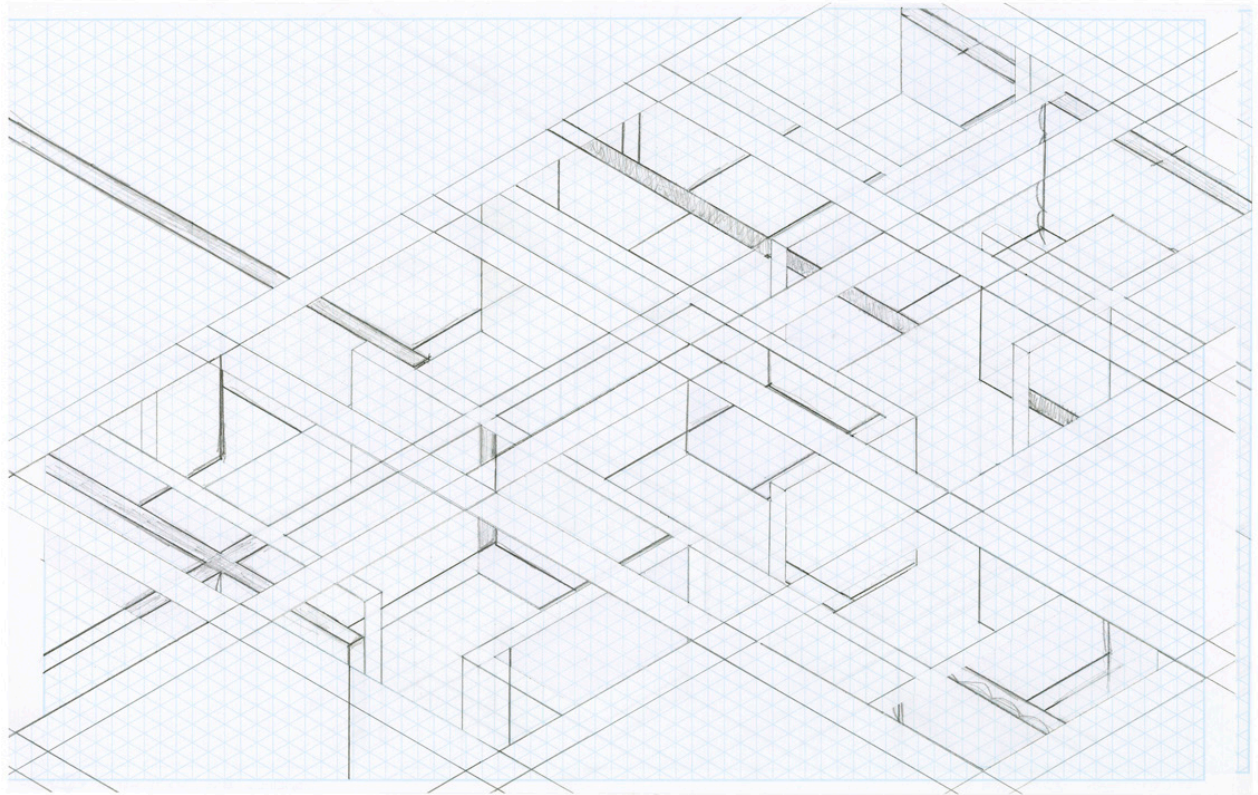

Lyla Rye

Deviation, Grid Cut Away, 2021

Archival Digital Print, 16 x 24 inches

Edition of 5

Value: \$1200

generalhardware.ca

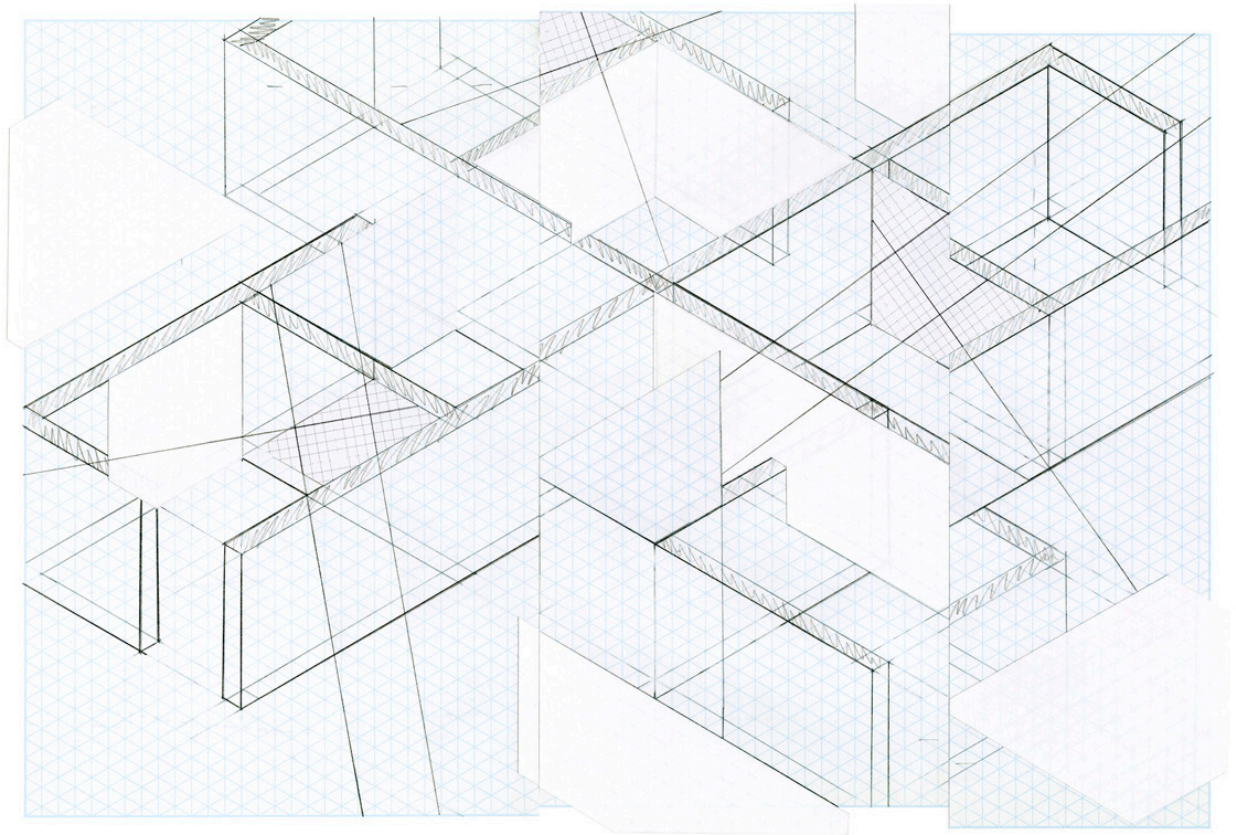

Lyla Rye

Deviation, Multi Grid Flip, 2021

Archival Digital Print , 16 x 24 inches

Edition of 5

Value: \$1200

generalhardware.ca

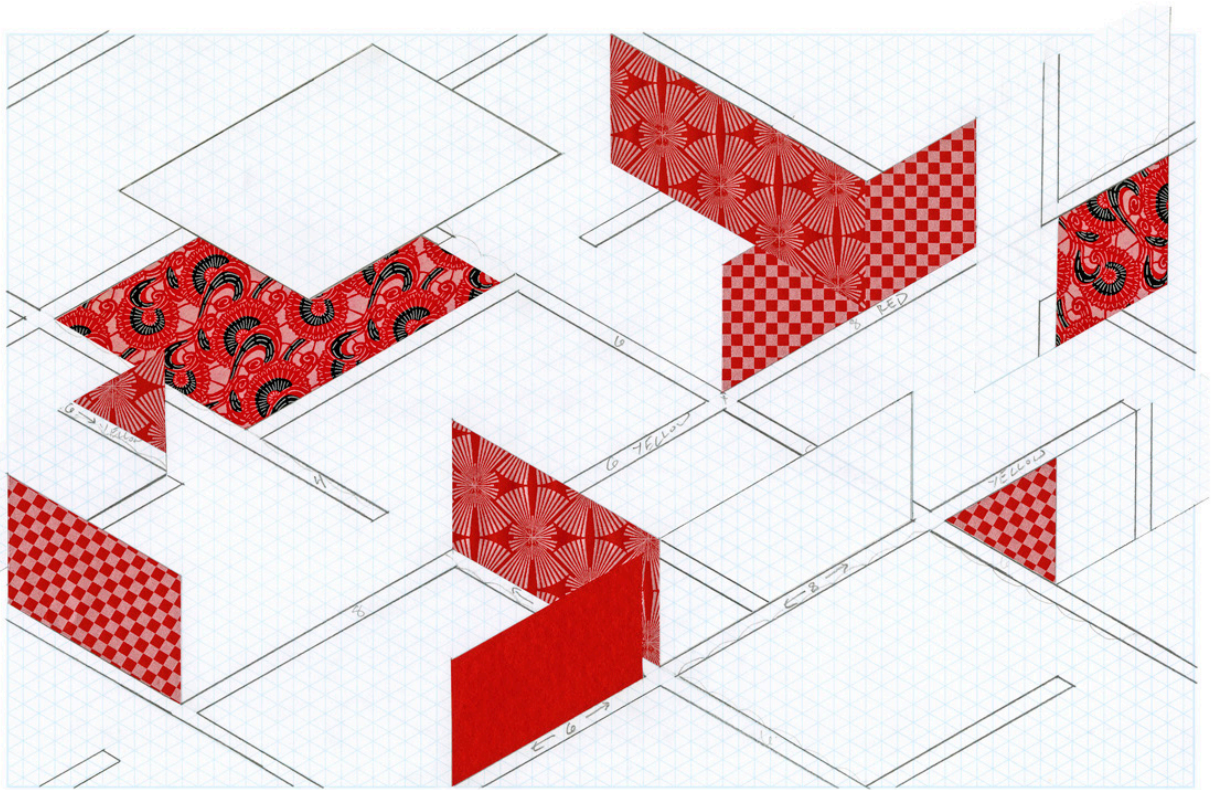

Lyla Rye

Deviation, Red Shoji, 2021

Archival Digital Print, 16 x 24 inches

Edition of 5

Value: \$1200

generalhardware.ca



Lyla Rye

Deviation, Orange Sand Map, 2021

Archival Digital Print with screen printing

16 x 24 inches

Edition of 5

Value: \$1200

generalhardware.ca

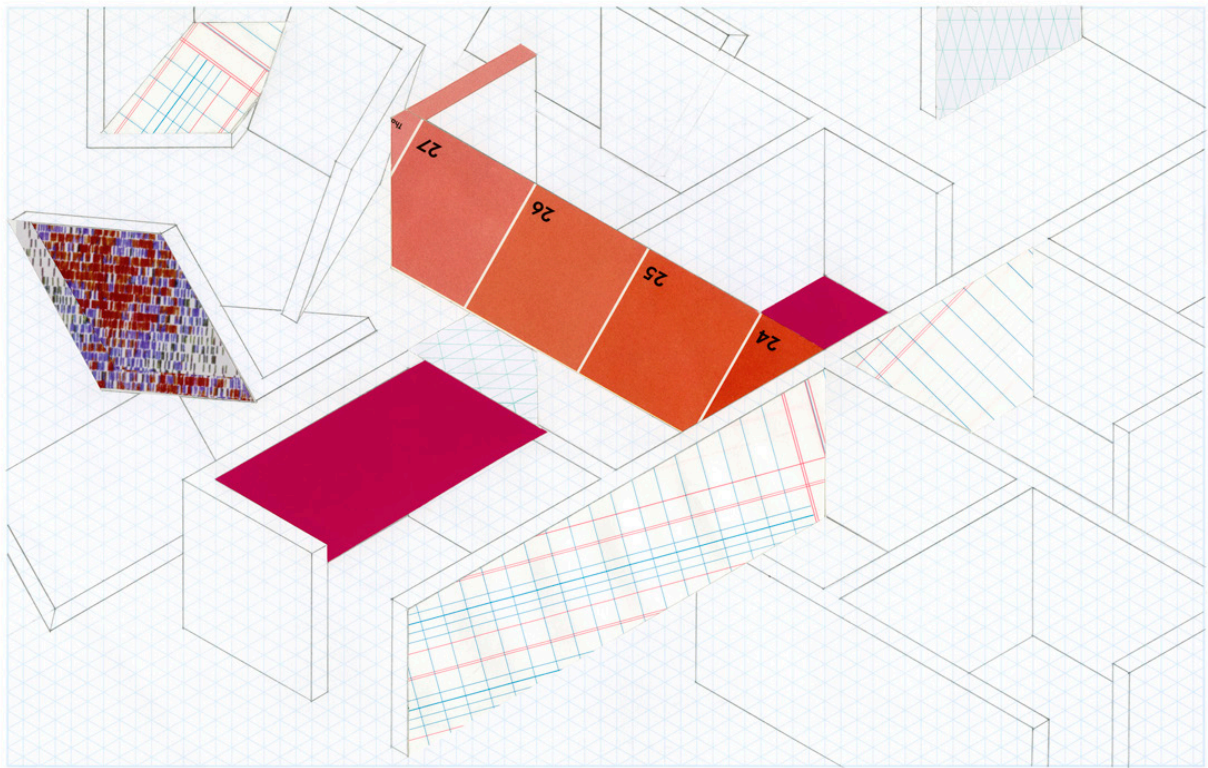

Lyla Rye

Deviation, Red Grids, 2021

Archival Digital Print, 16 x 24 inches

Edition of 5

Value: \$1200

generalhardware.ca

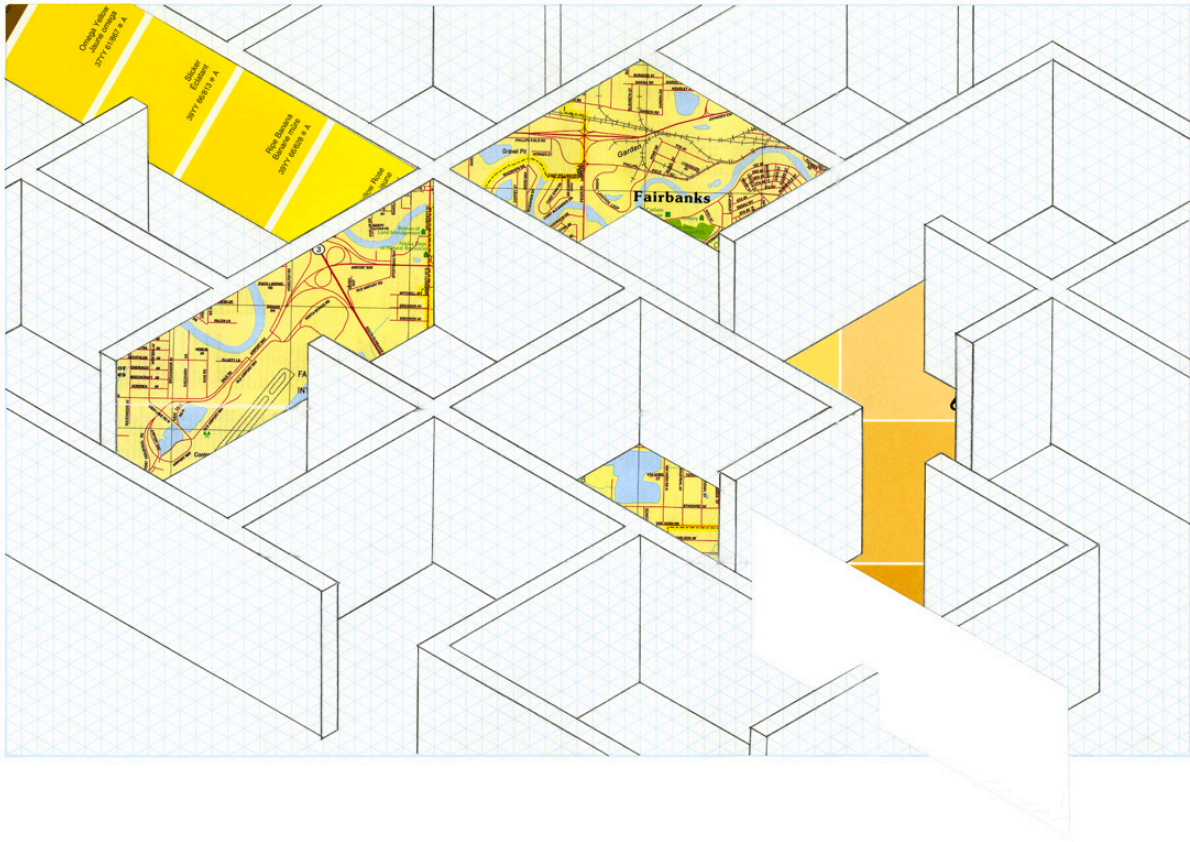

Lyla Rye

Deviations, Yellow Divisions, 2021

Archival Digital Print, 16 x 24 inches

Edition of 5

Value: \$1200

generalhardware.ca

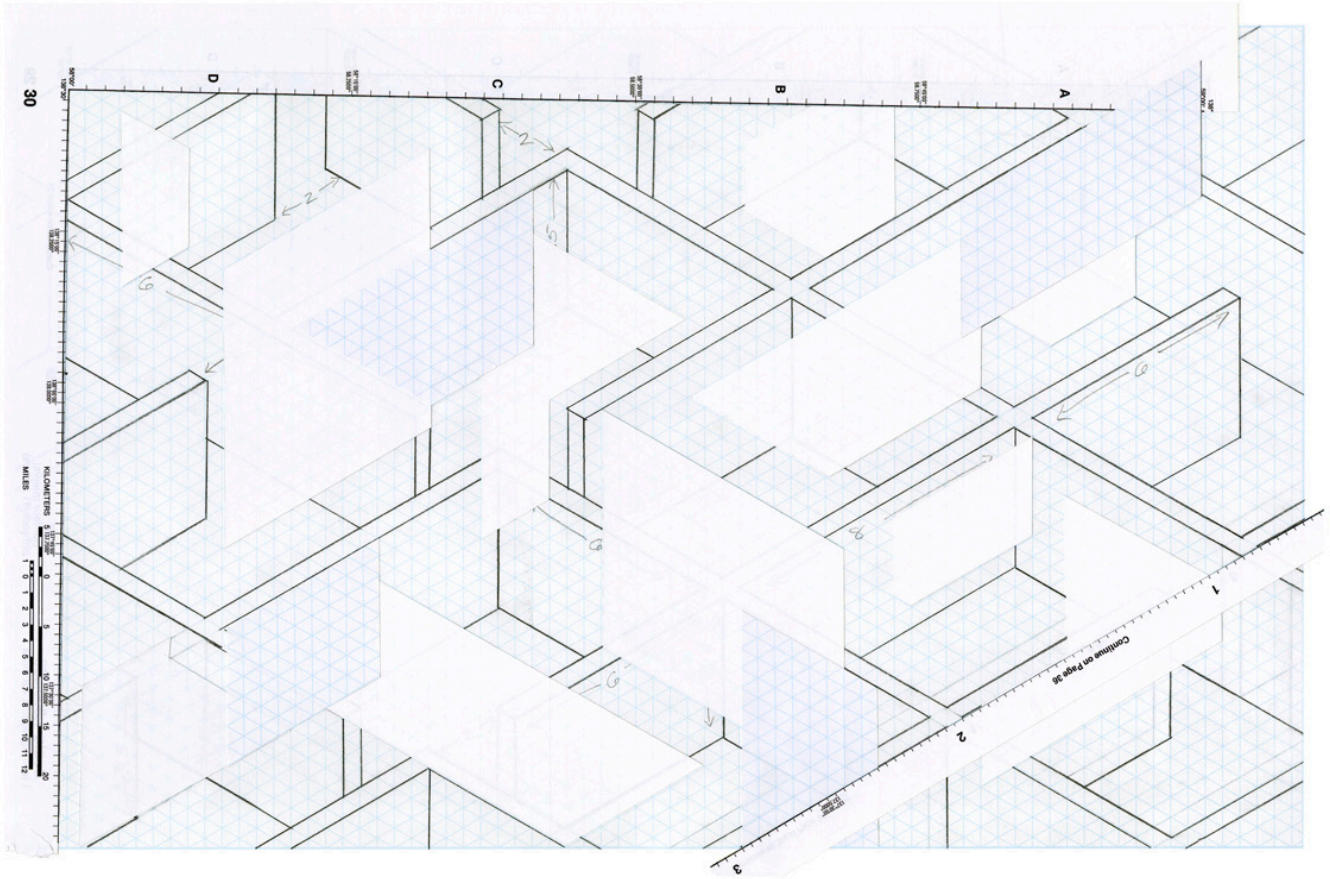

Lyla Rye

Deviation, White Walls, 2021

Archival Digital Print, 16 x 24 inches

Edition of 5

Value: \$1200

generalhardware.ca

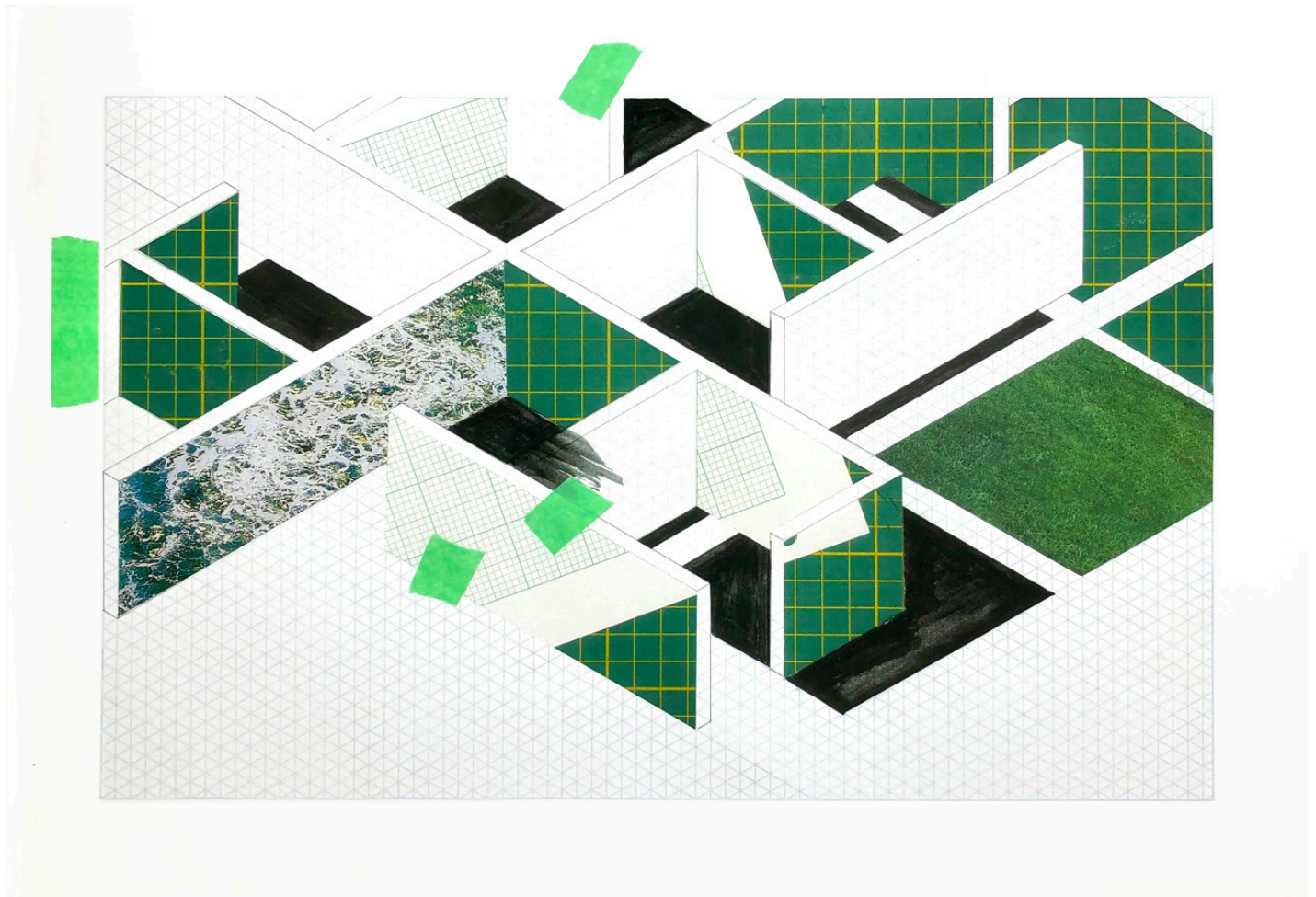

Lyla Rye

Deviation, Green Grid, 2021

Archival Digital Print on Canson Infinity Rag

16 x 24 inches

Edition of 5

Value: \$1200

generalhardware.ca



Lyla Rye

A Meditation - 2019

Three channel video installation

Duration: 22 minutes and 30 seconds with stereo audio

Audio: Debashis Sinha

Edition of 3, INQUIRE

This installation explores our ambivalent attitude to nature. While we indiscriminately treat land as a resource, we simultaneously use it as a source of comfort, as seen by the multitude of nature videos found online as meditation aids. In "A Meditation", an architectural scene constructed by these videos slowly scrolls by. Gradually the imagery shifts to reveal the inherent contradictions in our thinking about the natural world.

Exhibition History:

2020 Prefix Institute of Contemporary Art

2019 Karachi Biennale of Art (Karachi, Pakistan);

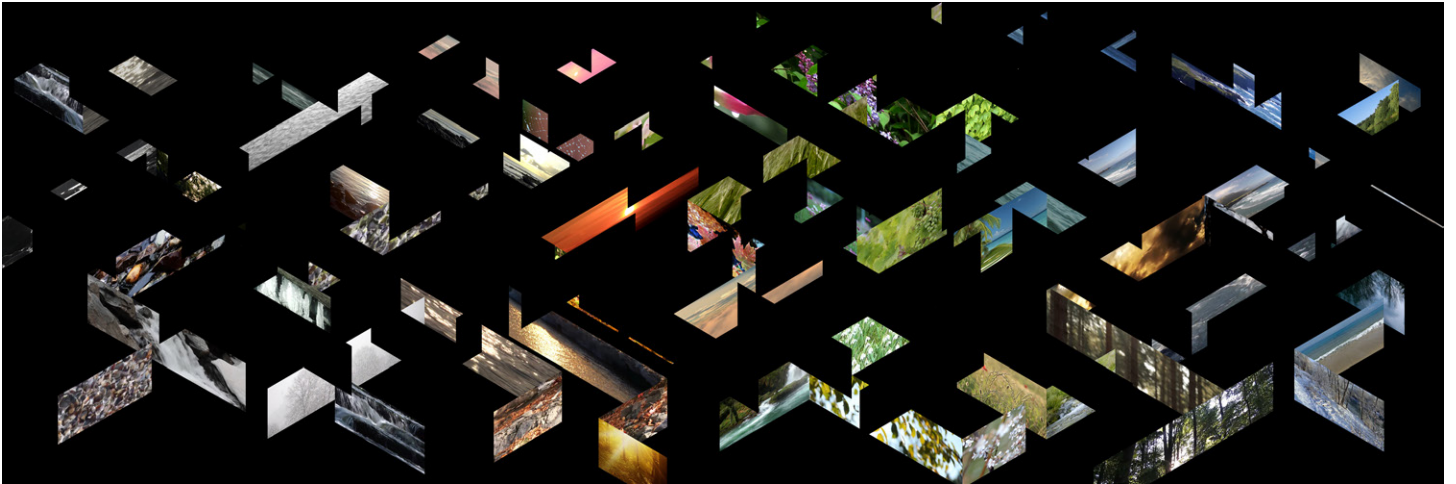

Lyla Rye
Suspended Meditation, 2020
Horizontal, 20" x 60"
archival print mounted to aluminum
Edition of 3
\$6400

generalhardware.ca



Lyla Rye
Suspended Meditation, 2020
Verticle, 60" x 20"
archival print, Edition of 3
\$6400

generalhardware.ca